

P-Series

11

P-Series



Plugs



PAG



PAG

Receptacles



PKG



PLG

Technical Characteristics

Climatical category	IEC 60068-1	55/175/21
Protection index(mated)	IEC 60529	IP50
Shock resistance	IEC 60512-4 test 6c	100g,6ms
Resistance to vibration	IEC 60512-4 test 6d	10-2000Hz,15g
Temperature Range	-40°C,+120°C	
Humidity	Up to 95% at 60%	
Endurance	IEC 60512-5 test 9a	>1000cycles
Characteristics	Standrad	Value

Panel-Dip Rear mount

PAG

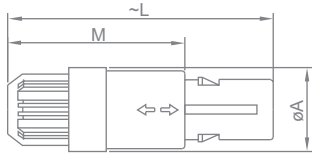

Reference		Dimensions(mm)		
Model	Series	A	L	M
PAG	1P	14	46.5	32

PAG

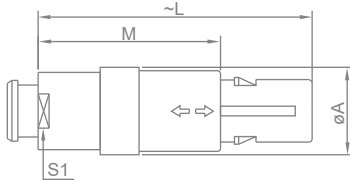

Reference		Dimensions(mm)			
Model	Series	A	L	M	S1
PAG	1P	14	45.5	32	9

PKG

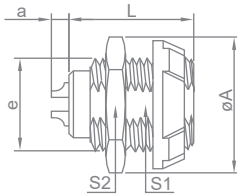

Reference		Dimensions(mm)					
Model	Series	A	L	a	e	S1	S2
PKG	1P	18.5	20.5	2.7	M14x1.0	12.5	17

PLG

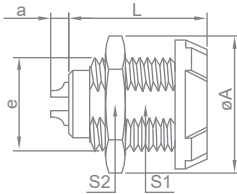

Reference		Dimensions(mm)					
Model	Series	A	L	a	e	S1	S2
PLG	1P	19.5	20.5	2.7	M14x1.0	12.5	17

Alignment Key



G=Standard Key



A=Two Keys with 40 degree



B=Two Keys with 60 degree



C=Two Keys with 80 degree

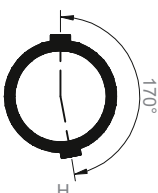

H=Two Keys with 170 degree

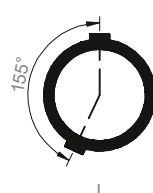

J=Two Keys with 155 degree

Insulator Configuration

1P	Socket side							
	Contact No.	2	3	4	5	6	7	8
	Insulator	02	03	04	05	06	07	08
	øA(MM)	1.3	1.3	0.9	0.9	0.7	0.7	0.7
1P	Socket side							
	Contact No.	9	10	12	14			
	Insulator	09	10	12	14			
	øA(MM)	0.5	0.5	0.5	0.5			

Part Numbering System

Cable :



Coding:

- G:0°
- A:40°
- B:60°
- C:80°
- H:170°
- J:155°

Material&Surface Plating:

- G:Grey PC
- K:Black PC
- U:Grey PSU

Insulator:

- P:PPS
- K:PEEK

Pin Number:02~14

Cable Collect:

- 39:2.7-3.9
- 52:4.0-5.2
- 65:5.3-6.5

Serial Code:

- G:Grey(Standard)
- Y:Yellow(Standard)
- B:Blue(Standard)
- K:Black(Standard)
- W:White(Standard)
- R:Red(Standard)
- N:Green(Standard)
- A:Grey(For Bend Relief)
- C:Yellow(For Bend Relief)
- D:Blue(For Bend Relief)
- E:Black(For Bend Relief)
- F:White(For Bend Relief)
- H:Red(For Bend Relief)
- J:Green(For Bend Relief)
- O:No Sealing Nut

Panel :

